

**Zubehörset für Einbruchhemmung
Gemäß Klasse 2 nach NEN 5096**
Sektionaltor Novoferm E Typ iso45-2,
Handbetätigung, Art.-Nr.: 66.071.001
- Montageanleitung -

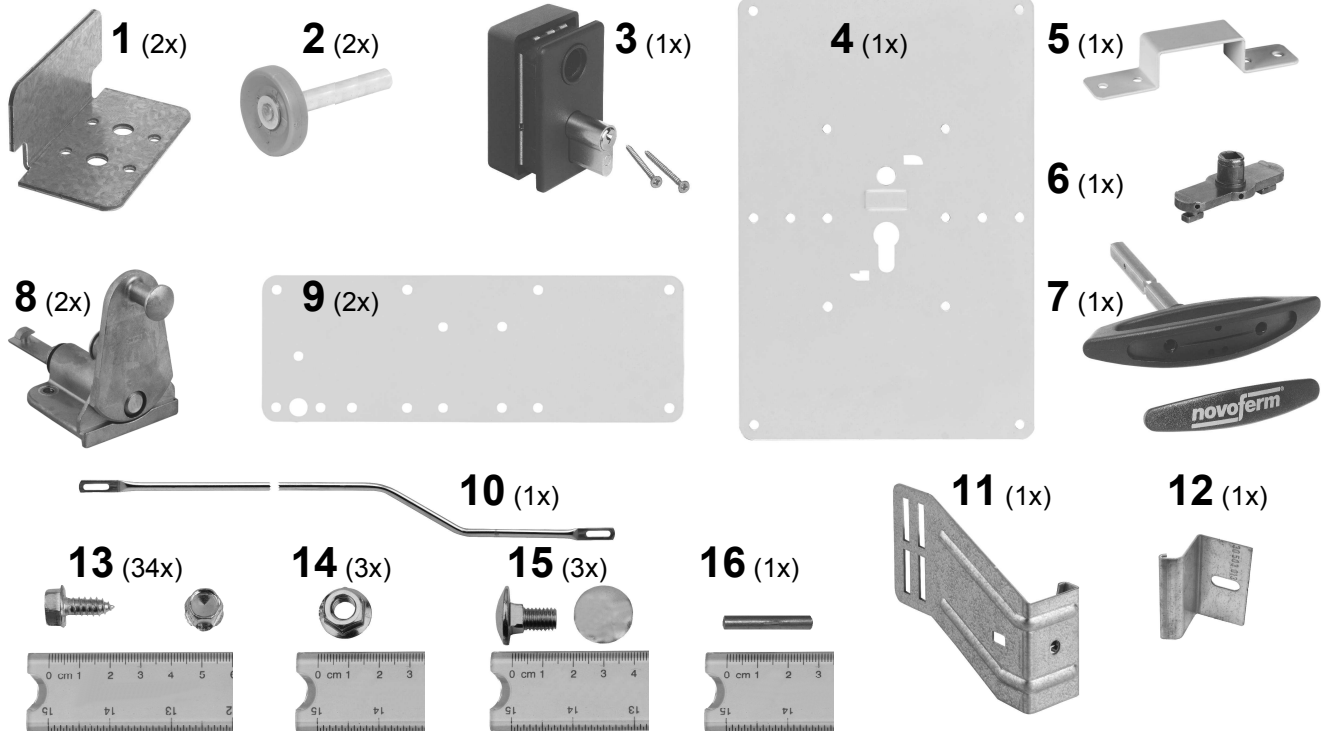

Inhalt:



Montage:

!!! Achtung !!!
Zum demontieren der unteren Seilbefestigung, muß gemäß Montageanleitung die Torsionsfeder entspannt werden.

1

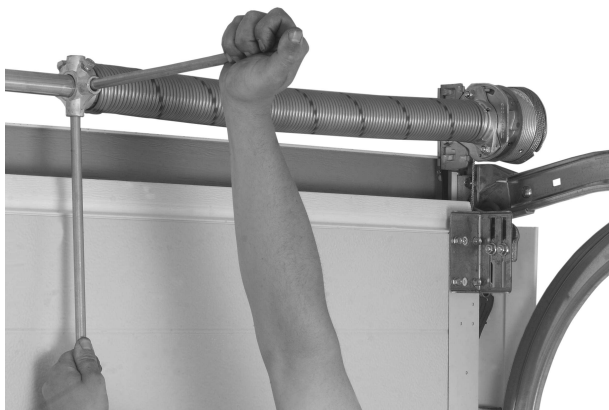

2

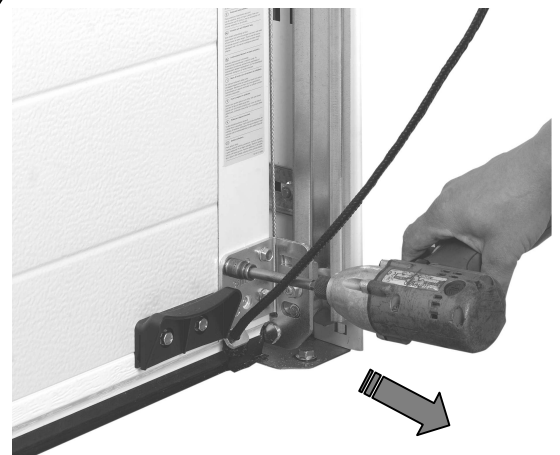

3



4

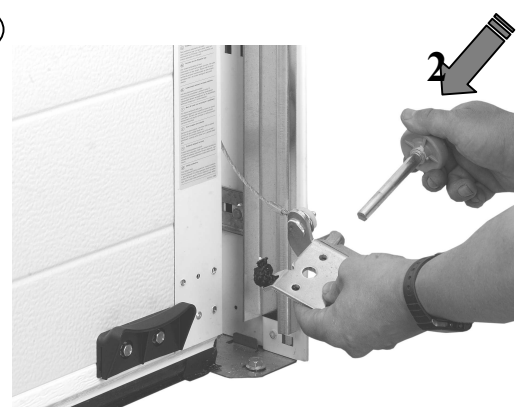

5



6



7

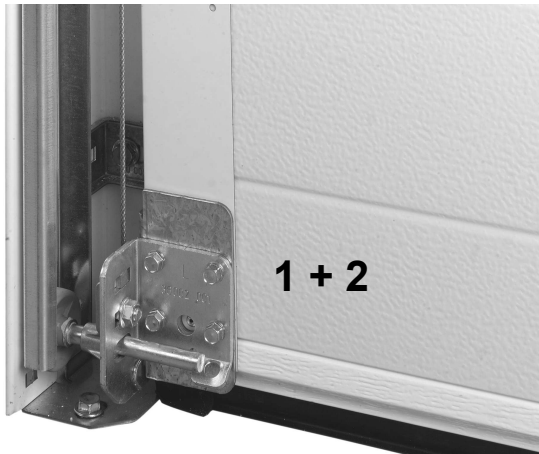

8

!!! Achtung !!!
Nach dem montieren der unteren
Seilbefestigung, muß gemäß
Montageanleitung die Torsionsfeder
wieder gespannt werden.



9

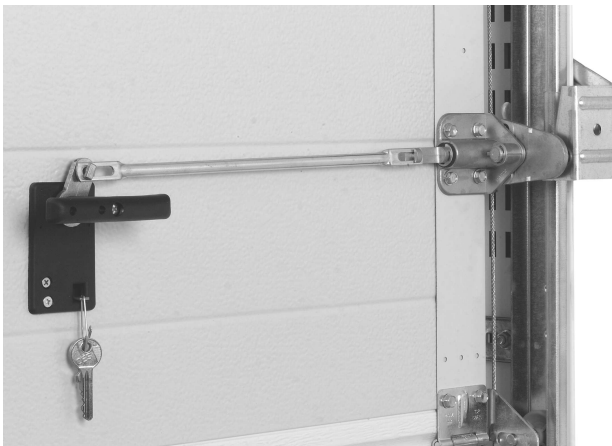

10

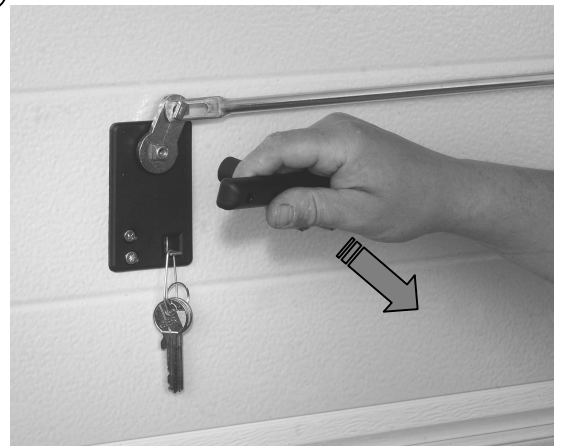

11



12

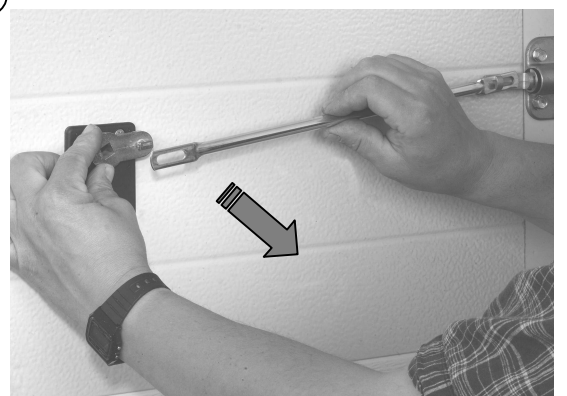

13



14

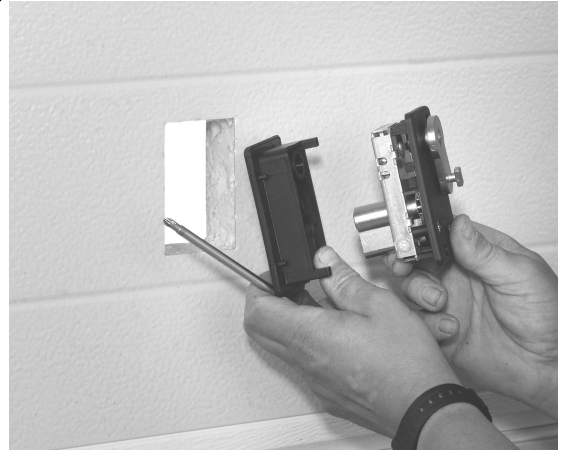

15

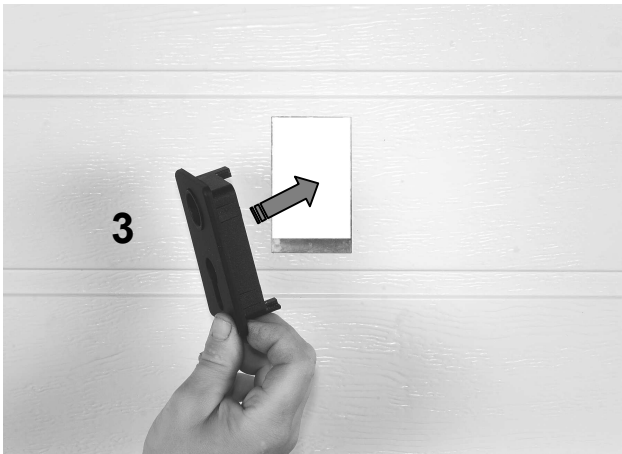

16

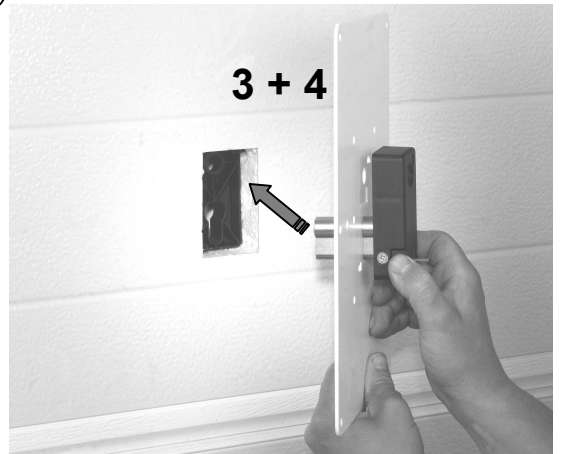

17

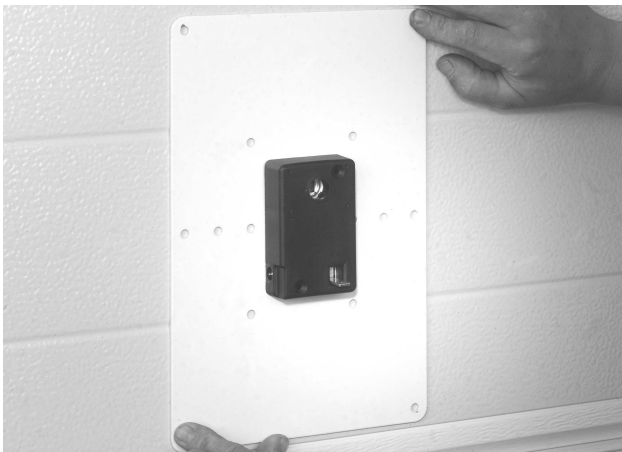

18



19



20



21



22

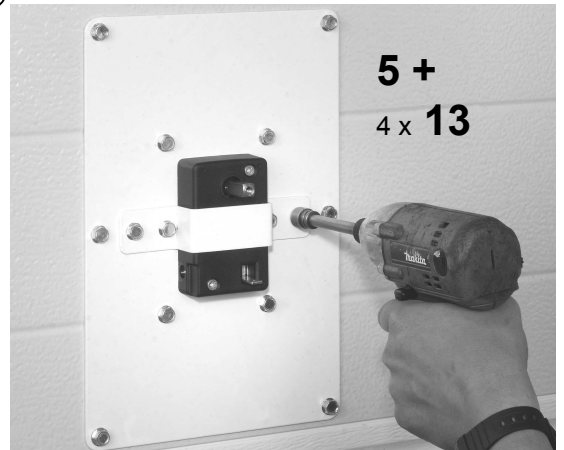

23



24



25

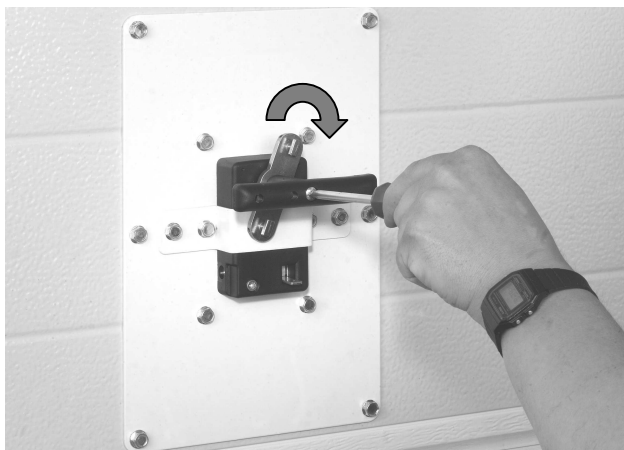

26



27

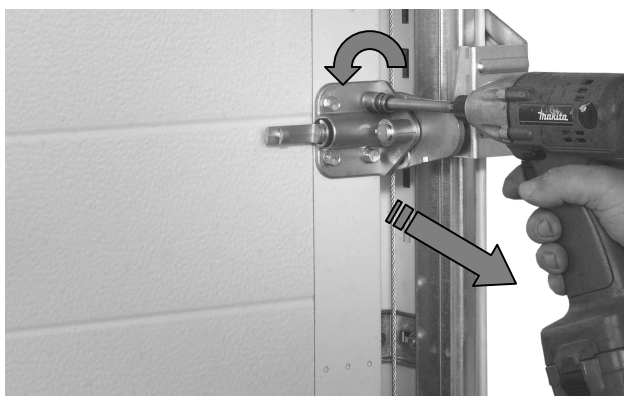

28

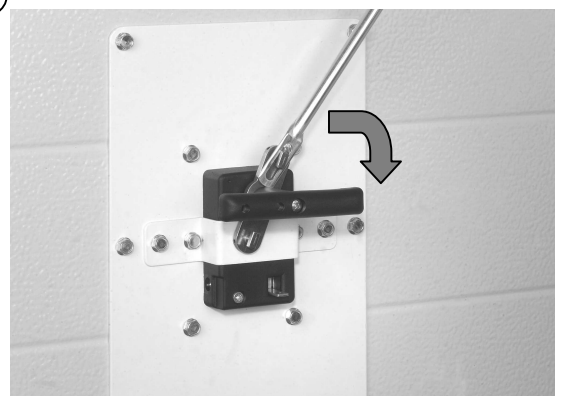

29

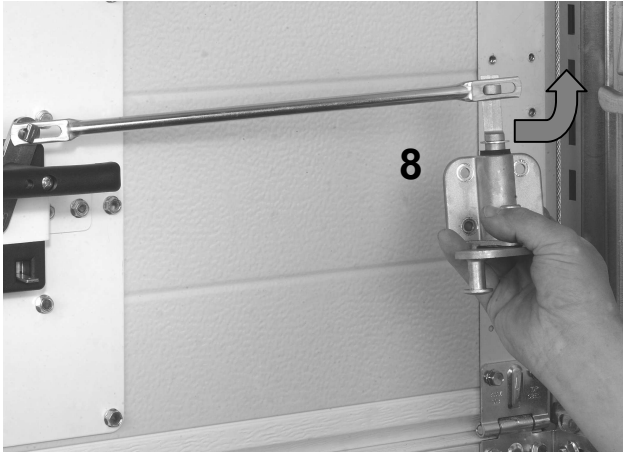

30

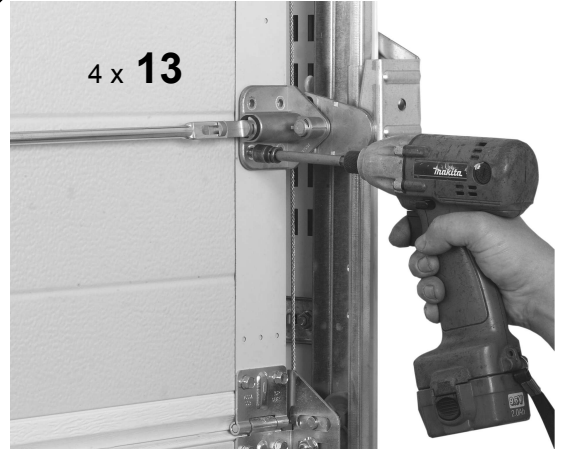

31

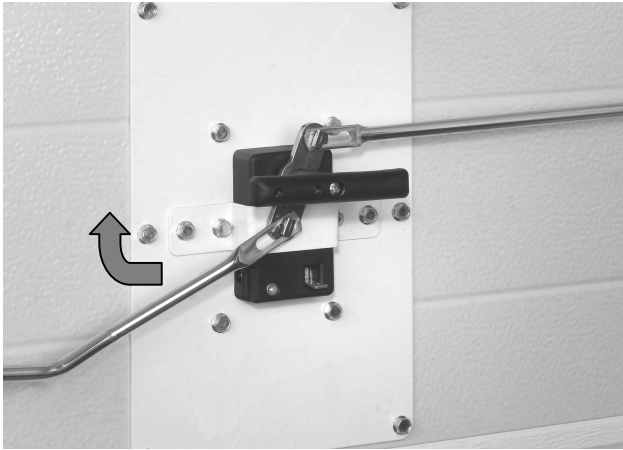

32

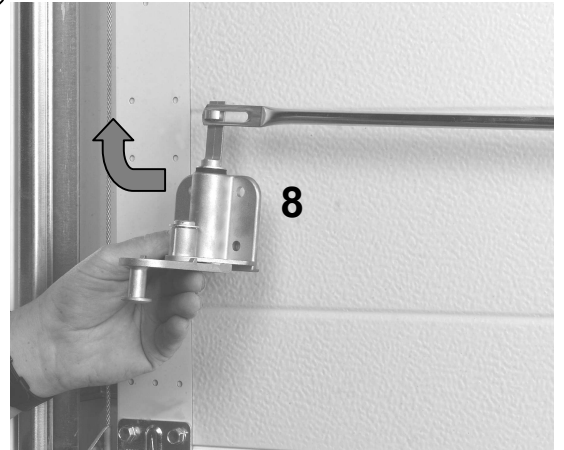

33

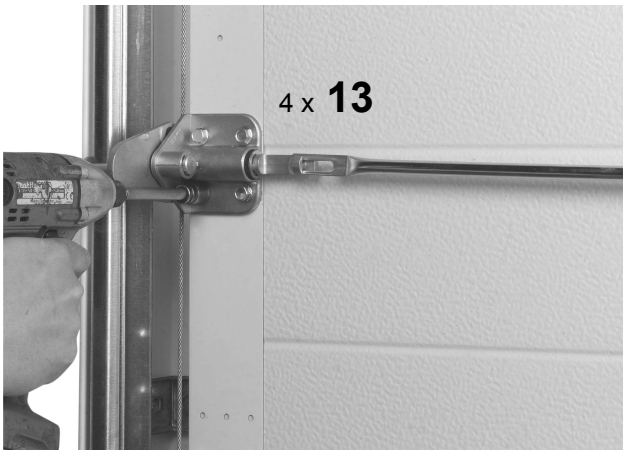

34

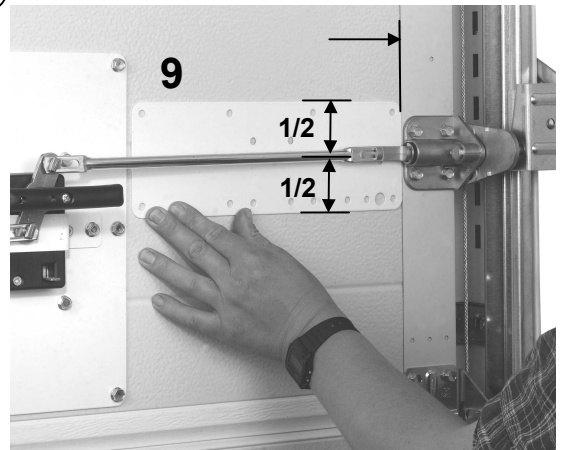

35



36



37

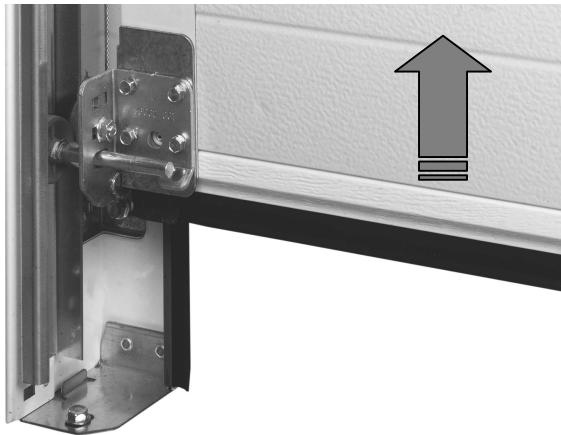

38

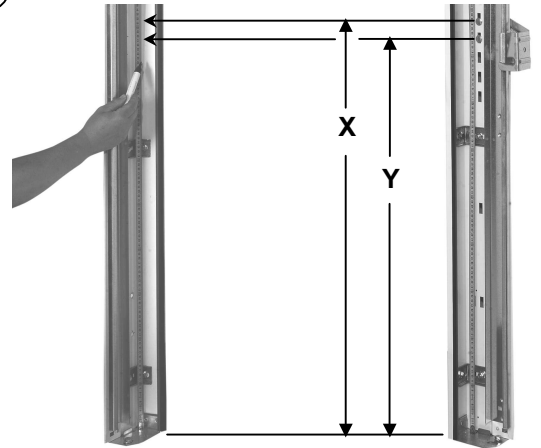

39

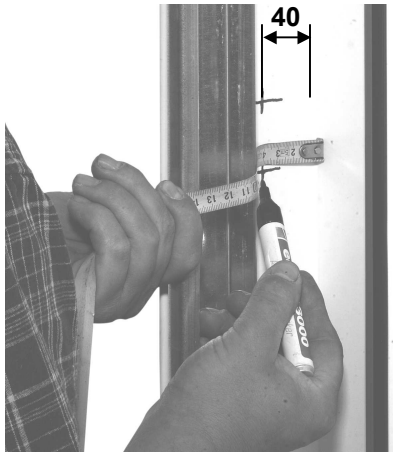

40



41

- 11**
- + 2 x 15**
- + 2 x 14**

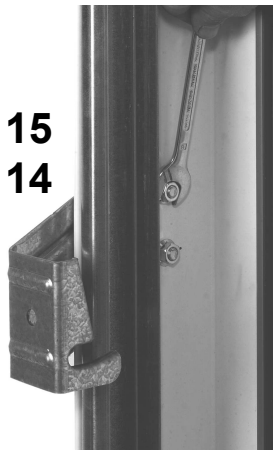

42

- 12**
- + 1 x 15**
- + 1 x 14**



43

